

Steve Hanson
Head Golf Professional

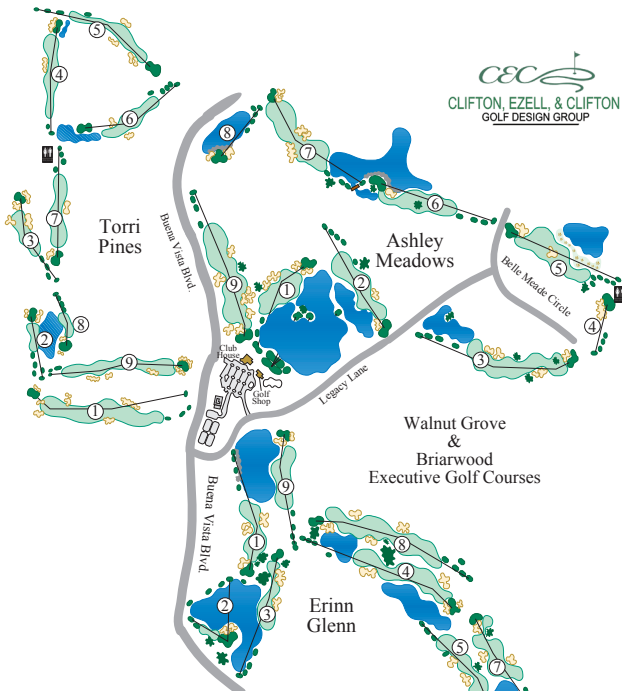

Rickey Craig
Vice President of Golf



17145 Buena Vista Blvd.
The Villages, FL 32162
352-753-1450
www.GolfTheVillages.com

554	224	325	366	429/470	398	370	168	515	3349/3390
534	185	315	361	389	368	366	164	498	3180
513	151	290	340	366	345	351	150	480	2986
438	113	265	317	306	323	330	128	465	2685
430	105	235	265	238	269	271	100	389	2302
310	66	195	190	202	220	230	96	312	1821
1	2	3	4	5	6	7	8	9	TOTAL
:16	:28	:42	:56	1:10	1:24	1:38	1:50	2:06	
TORRI PINES									
5	3	4	4	4	4	4	3	5	36
/									
/									
/									
2	8	7	6	1	4	3	9	5	
3	9	7	6	4	1	5	8	2	

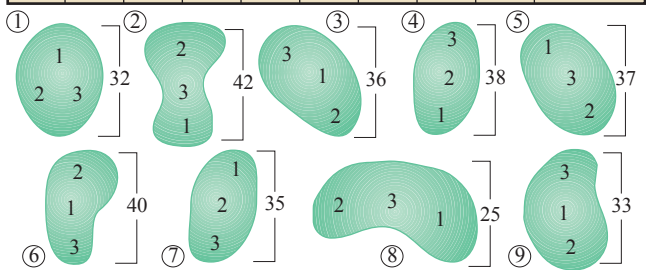

The Nancy
LOPEZ LEGACY
Country Club

The Villages

DATE: _____
SCORER: _____
ATTEST: _____



BLACK	5 or less	346	392	536	174	418	389	412	212	507	3386
GOLD	10 or less	340	389	503	168	397	361	372	182	502	3214
BLUE	Men 19 or less Ladies 5 or less	322	346	493	142	371	340	343	162	485	3004
WHITE	Men All Hcp Ladies 15 or less	280	326	459	124	338	284	306	130	470	2717
GREEN	All handicaps	241	249	400	89	299	278	275	124	394	2349
FRIENDLY		195	200	285	87	215	218	191	61	320	1772
HOLE		1	2	3	4	5	6	7	8	9	TOTAL
TIME PAR		:14	:28	:44	:56	1:10	1:24	1:38	1:50	2:06	
+/-											
ASHLEY MEADOWS											
PAR		4	4	5	3	4	4	4	3	5	36
+/-											
MEN'S HCP		8	4	1	9	7	2	5	6	3	
LADIES' HCP		7	4	1	9	3	6	5	8	2	

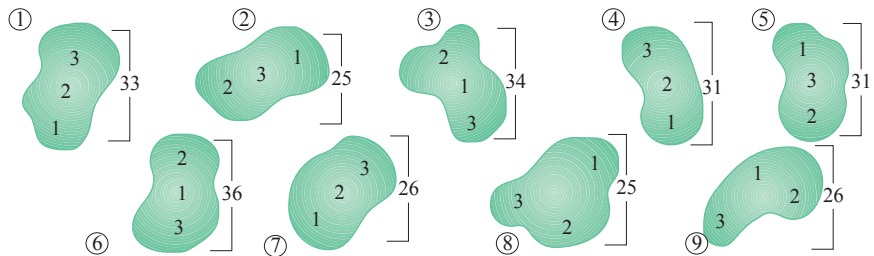

USGA RULES WILL GOVERN ALL PLAY ALONG WITH THE FOLLOWING RULES.

- **Alternative to Stroke and Distance for a Ball That is Lost or Out of Bounds** is in effect. Please see Club's Local Rules Sheet for details.
- **Out of Bounds** is defined by:
 1. The inside edge of white stakes or lines, all walls, and wooden fences.
 2. In the absence of stakes, the inside edge of street curbs, paved public roads, or transportation trails.
- **Penalty Areas** are identified by Red Stakes and defined by Red Lines
- **No Play Zone-Abnormal Course Condition** The areas defined by Blue Stakes with Green Tops, [Specifically along Villa Walls on Ashley #4, #5, #8, Torri #6, and Erinn #1] are **no play zones** and are to be treated as an **abnormal course condition**. Free relief **MUST** be taken from interference by the **no play zone** under Rule 16.1f. There is no relief from Cord Grass or any landscaping outside the "No Play" zones.
- **Ground Under Repair**, which allows free relief under the following conditions
 1. Areas enclosed by white lines
 2. Any unusual damage caused by maintenance vehicles, golf carts or the like
 3. Any newly sodded areas; relief is permitted for the lie of the ball only.
 4. Staked Trees and/or built up tree wells.
- In the event of an odd course handicap, the extra stroke is applied to the first nine played.

Etiquette

- Expected Time Par is 4 hours & 15 minutes
- Please observe The Villages' dress code.
- Maximum of two people per cart and each player must have their own clubs.
- Please repair ball marks on the putting green, rake bunkers and fill divots in the fairways with sand.
- Golf cars must remain on paths on par 3's and around all tees and greens. Please observe 90° rule at all times.

For Golf Course and Slope Ratings, please refer to GolfTheVillages.com or FSGA.org

Course is proudly irrigated with reclaimed water
Do Not Drink (No Beber)



385	202	452	568	410	179	400	557	359	3512
371	183	425	542	384	175	390	522	345	3337
340	169	400	527	360	155	369	492	331	3143
280	140	345	468	300	146	287	473	310	2749
255	113	295	430	265	89	275	438	270	2430
200	78	235	375	225	80	192	314	231	1930
1	2	3	4	5	6	7	8	9	TOTAL
:14	:26	:40	:56	1:10	1:22	1:36	1:52	2:06	
+/-									
ERINN GLENN									
4	3	4	5	4	3	4	5	4	36
5	8	6	1	3	7	2	9	4	
7	8	3	1	4	9	6	2	5	

